

ALLDAY  
& MILLER



Coombe Drive, Ruislip, HA4 9TW  
£715,000

 4  2  2  D



Coombe Drive, Ruislip, HA4 9TW

**£715,000**

- Four Bedrooms
- Backing Bessingby Park
- Within Reach Of Well Regarded Schools
- Quiet Location
- Semi Detached
- Loft Conversion
- Large Driveway
- Conservatory
- Close To Eastcote Station
- Ground Floor W.C.

## Description

This bright and spacious semi detached home is offered for sale in good condition, ideal for family living, offering accommodation as follows. To the ground floor there is a hallway that provides access to the 21ft living/dining room, that in turn offers access to the conservatory that overlooks the rear garden. There is also a 12ft fitted kitchen and downstairs cloakroom whilst to the first floor are three of the well proportioned bedrooms in addition to the family bathroom. The second floor has a 14ft master bedroom with views to the rear of Cavendish Recreation Ground and beyond, there is also a spacious en-suite and walk-in wardrobe.

The front has hardstanding with parking for at least three cars. The rear garden is approx. 60 ft with patio and lawn.

## Situation

Located on one of Ruislip Manor's popular roads, Coombe Drive is in close proximity to both Ruislip Manor and Eastcote High Streets offering trendy eateries, shops and transport - Ruislip Manor or Eastcote tube stations (Metropolitan /Piccadilly). Whilst South Ruislip (Central line/BR) station is a 5 minute drive away. For the motorist the A40/M40 and M25 road links offering easy access to London and the Home Counties. For families, it is in the catchment area for excellent local schools Newnham, Ladybankes, Haydon and Bishop Ramsey. Bessingby and Cavendish Parks are also a short walk away.



## Floor Plans

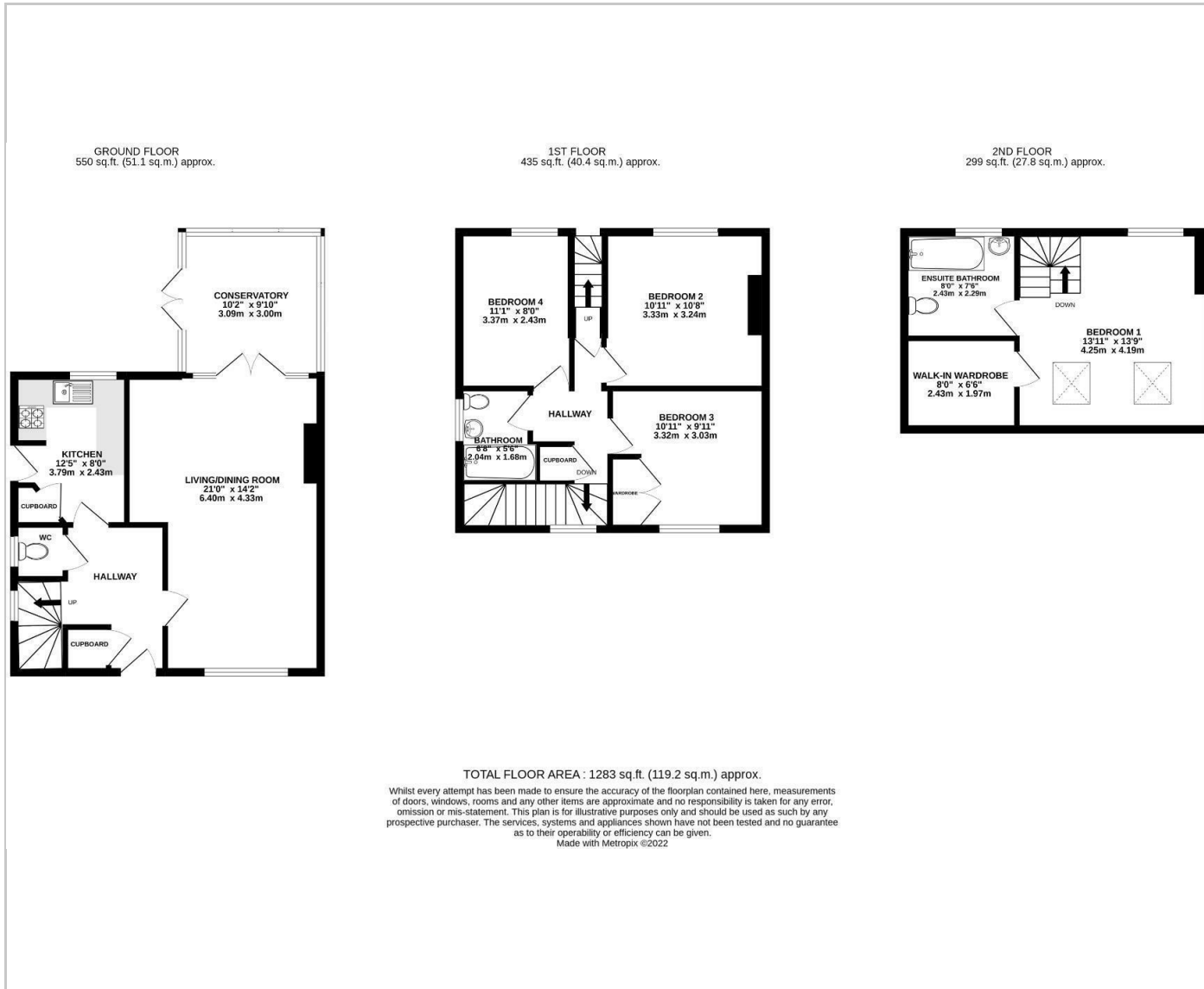

## Area Map

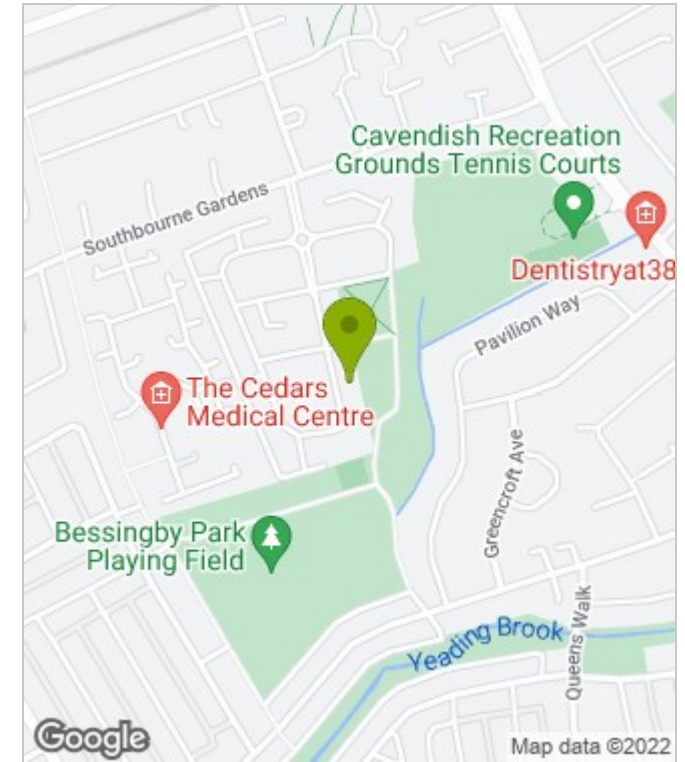

## Energy Performance Graph

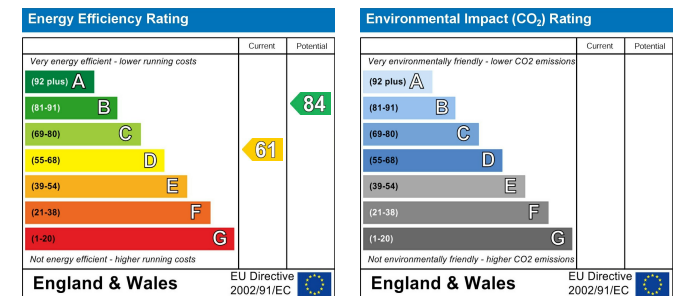

These particulars, whilst believed to be accurate are set out as a general outline only for guidance and do not constitute any part of an offer or contract. Intending purchasers should not rely on them as statements of representation of fact, but must satisfy themselves by inspection or otherwise as to their accuracy. No person in this firm's employment has the authority to make or give any representation or warranty in respect of the property.